

FRP VALVES

BI-SEAL

AUSTRALIA PTY LTD

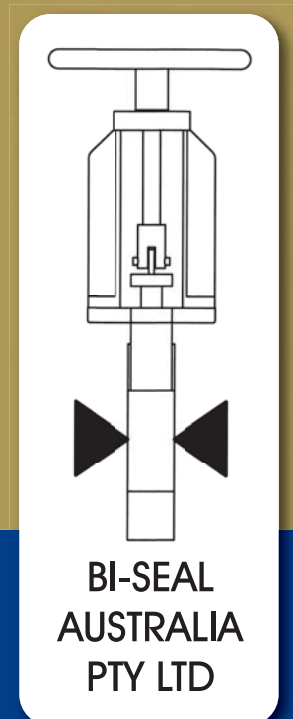

BI-SEAL AUSTRALIA PTY LTD

37 Lipton Drive, Thomastown VIC 3074

Phone: +61 3 9462 4457 Fax: +61 3 9462 4452

Email: vtmaustralia@bigpond.com

**BI-SEAL
AUSTRALIA
PTY LTD**

BI-SEAL

AUSTRALIA PTY LTD

FRP VALVES

OPERATION

- Handwheel (standard)
- Air, Oil or Water Cylinders
- Electric
- Bevel Gear
- Chainwheel

OPTIONS

- Bonneted
- Flush Ports
- V Port
- Locking Device

WHEN REPLACING PARTS

- Depressure the installed valve and remove from pipeline
- Remove the superstructure and gland
- Remove the bolts holding the two identical body halves together
- Replace any worn components
- Re-assemble and repack gland
- Pressure test for body sealing and seat sealing integrity
- Return the valve into service or storage
- Remember to re-order parts used

DESIGN FEATURES

- The FRP Valve is a bi-directional knife gate valve available in a variety of body and seat materials
- Designed and manufactured in Australia
- Available in sizes from 50mm up to 750mm
- Australian and international flange drilling available
- Replacement kit consists of a gate, a steel reinforced elastomeric gate and body seal and two identical steel reinforced elastomeric bore liners
- Substantial stainless steel operating spindle
- Live loaded gland
- Superstructure designed for easy retro fit of cylinder operation or gearbox
- Metallic bore and chest liner fitted upon request (consult factory for appropriate metallic liners)
- Generally in accordance with MSS SP-81 face to face dimensions
- Optional full elastomeric lining

WARNING

BI-SEAL AUSTRALIA PTY LTD valves and valve actuators are designed and manufactured using high quality workmanship and materials and meet all applicable industry standards. The valves are available with components of various materials and should be used only in services for which they are fit for purpose. Misapplication of the product may result in injuries or property damage. A selection of valve components of the proper materials, consistent with the particular performance requirements, is important for safety and reliability.

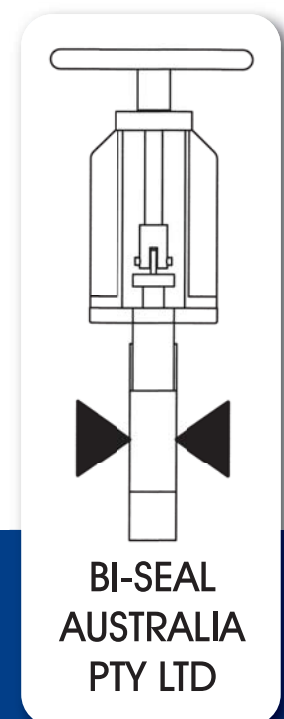
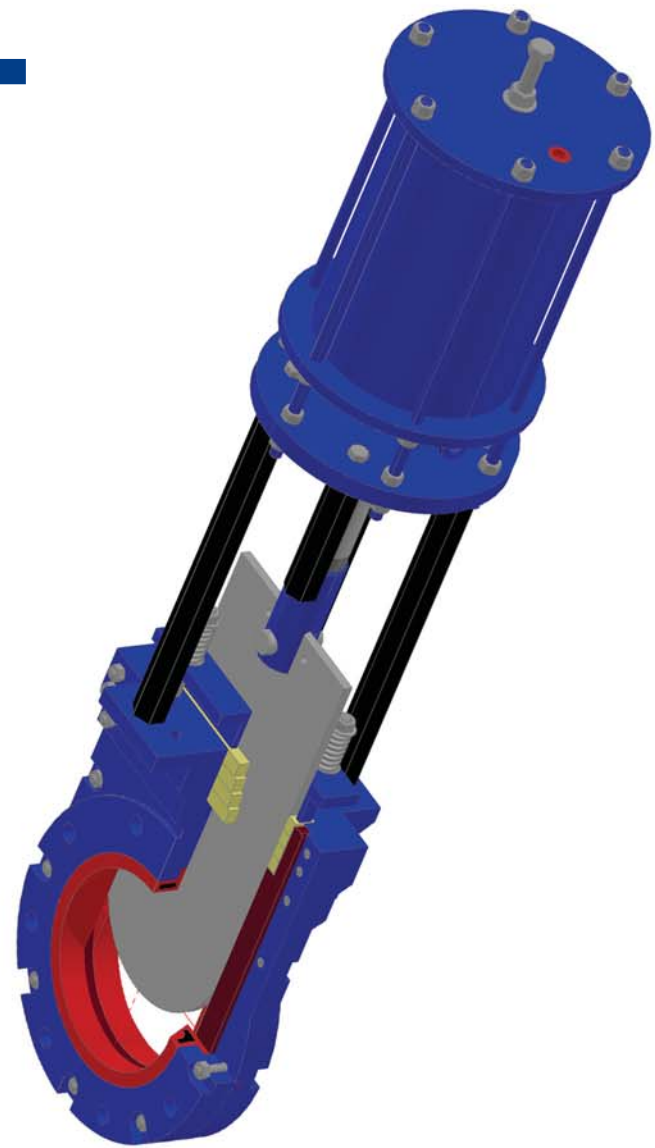

BI-SEAL AUSTRALIA PTY LTD

37 Lipton Drive, Thomastown VIC 3074

Phone: +61 3 9462 4457 Fax: +61 3 9462 4452

Email: vtmaustralia@bigpond.com

BI-SEAL
AUSTRALIA
PTY LTD